

Courses & Distances on the river and Creek
Beginning at the post on river thence down to

S 31 W 30 Perches

S 15 W 68

South 31

S 17 W 26

S 46 W 33

188

to the mouth of Brokenstraw thence up to

N 36 1/2 W 127 1/4

N 25 W 68

N 46 W 31 1/4

S 72 W 47 to a Post

274 1/4

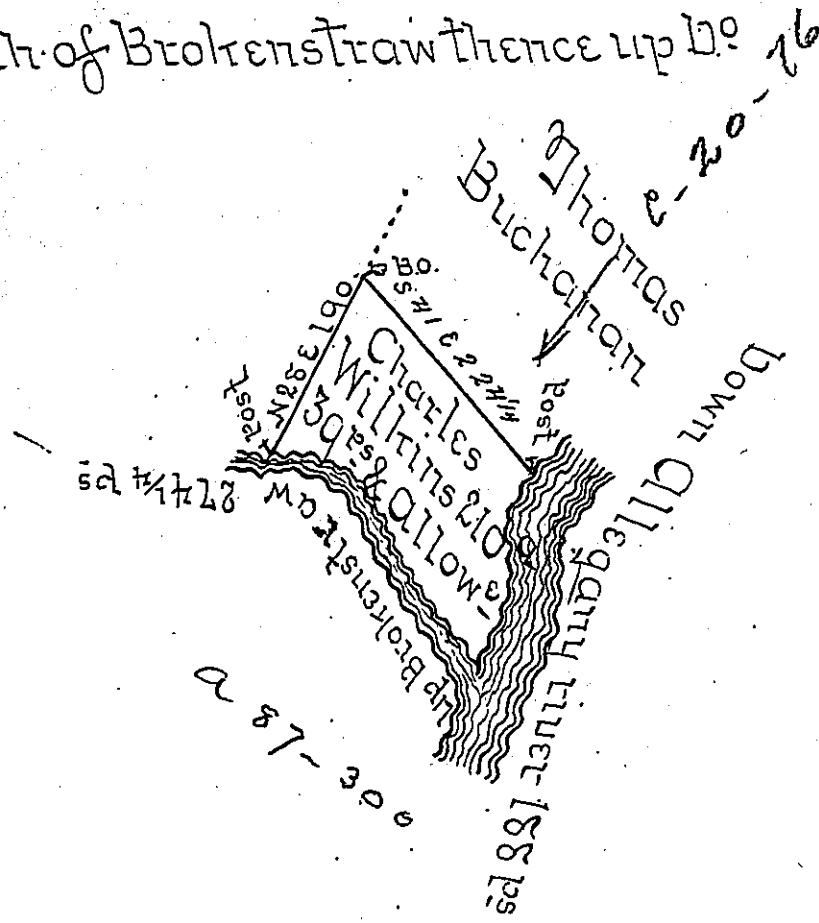

Surveyed on the 27th June ¹⁷⁹⁵ the above described tract of
land in District No 6. In pursuance of a Warrant to Charles
Wilkins dated the 30th Day of April 1792. Containing two hun-
dred and Ten Acres and 39 Perches and Allowance of six P
Cent &c.

Sam^l Nicholson D.S.

To Daniel Brodhead Esq^r }
Surveyor General }

IN TESTIMONY that the above is a copy of the original remaining on file in
the Department of Internal Affairs of Pennsylvania, made
conformably to an Act of Assembly approved the 16th day of
February, 1833, I have hereunto set my Hand and caused
the Seal of said Department to be affixed at Harrisburg,
this seventh day of January 1902.

James W. Pitta
Secretary of Internal Affairs.